

C型铁芯/C Core

欧标SG-, FA-, HWR-系列
SG-, FA-, HWR-series

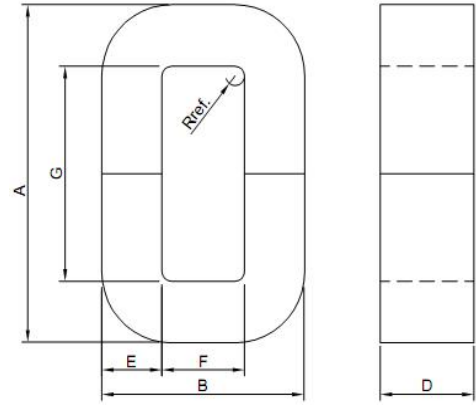

铁芯型号 Code				铁芯尺寸/Dimension (mm)										铁芯 重量
SG-	FA-	HWR-	IEC 329	G min	F min	A		B max	D		E		R mm	Weight Kg
						max	Tol		min	Tol	min	Tol		
SG27/6	D06	3/4	Q 1.1	14.3	6.4	29.4	-2.4	21	7.2	-0.8	7.2	-0.8	1.0	0.018
SG33/8	F08	4/5	Q 2.1	17.5	7.9	35.7	-	25.8	8.7	-0.8	8.7	-	-	0.035
SG41/9	H10	5/6	Q 3.1	22.2	9.5	43.7	-	30.6	10.3	-0.8	10.3	-	-	0.063
SG48/9	J10	7/6	Q 4.1	28.6	11.1	50	-	32.1	10.3	-0.8	10.3	-	-	0.073
SG54/13	Q13	10/8	Q 5.1	38.1	12.7	56.4	-2.1	30.6	13.5	-0.8	8.7	-0.8	1.5	0.094
SG54/19	Q19	10/12	Q 5.2	-	-	-	-	-	19.8	-	-	-	-	0.141
SG54/25	Q25	10/16	Q 5.3	-	-	-	-	-	26.2	-	-	-	-	0.187
SG54/38	Q38	10/24	Q 5.4	-	-	-	-	-	38.9	-	-	-	-	0.281
SG70/13	T13	30/8	Q 6.1	50.8	15.9	73	-3.2	36.9	13.5	-0.8	10.3	-0.8	1.5	0.145
SG70/19	T19	30/12	Q 6.2	-	-	-	-	-	19.8	-	-	-	-	0.218
SG70/25	T25	30/16	Q 6.3	-	-	-	-	-	26.2	-	-	-	-	0.291
SG70/32	T32	30/20	Q 6.4	-	-	-	-	-	32.5	-	-	-	-	0.363
SG76/19	U19	40/12	Q 7.1	57.2	19	79.4	-3.2	40.1	19.8	-0.8	10.3	-0.8	3.0	0.239
SG76/25	U25	40/16	Q 7.2	-	-	-	-	-	26.2	-	-	-	-	0.319
SG76/32	U32	40/20	Q 7.3	-	-	-	-	-	32.5	-	-	-	-	0.398
SG76/38	U38	40/24	Q 7.4	-	-	-	-	-	38.9	-	-	-	-	0.478
SG89/22	V22	50/14	Q 8.1	63.5	22.2	92.1	-3.2	49.6	23.0	-0.8	13.5	-0.8	3.0	0.432
SG89/29	V29	50/18	Q 8.2	-	-	-	-	-	29.4	-	-	-	-	0.553
SG89/38	V38	50/24	Q 8.3	-	-	-	-	-	38.9	-	-	-	-	0.739
SG89/51	V51	50/32	Q 8.4	-	-	-	-	-	51.6	-	-	-	-	0.989
SG108/19	X19	70/12	Q 9.1	76.2	28.6	111.1	-3.2	62.3	19.8	-0.8	16.7	-0.8	3.0	0.567
SG108/29	X29	70/18	Q 9.2	-	-	-	-	-	29.4	-	-	-	-	0.898
SG108/38	X38	70/24	Q 9.3	-	-	-	-	-	38.9	-	-	-	-	1.140
SG108/51	X51	70/32	Q 9.4	-	-	-	-	-	51.6	-	-	-	-	1.520
SG127/25	Z25	90/16	Q 10.1	88.9	34.9	130.2	-3.2	75	26.2	-0.8	19.8	-0.8	3.0	1.080
SG127/38	Z38	90/24	Q 10.2	-	-	-	-	-	38.9	-	-	-	-	1.620
SG127/51	Z51	90/32	Q 10.3	-	-	-	-	-	51.6	-	-	-	-	2.160
SG127/70	Z70	90/44	Q 10.4	-	-	-	-	-	71.4	-	-	-	-	2.970
SG165/32	AD32	110/20	Q 11.1	114.3	44.4	169.9	-4.7	97.2	32.5	-0.8	26.2	-0.8	3.0	2.360
SG165/51	AD51	110/32	Q 11.2	-	-	-	-	-	51.6	-	-	-	-	3.770