

C型铁芯/C Core

欧标SE系列/SE-series

欧标SM系列/SM-series

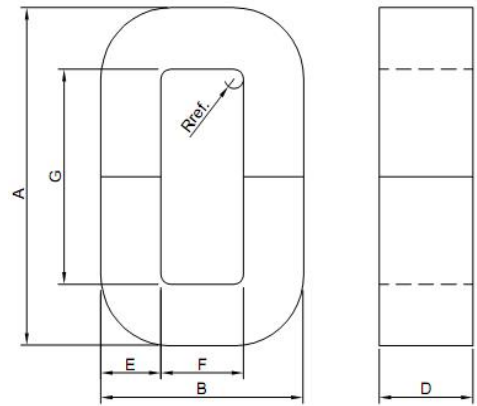

铁芯型号 Code	铁芯尺寸/Dimension (mm)									磁路 长度 Flux path L(cm)	截面积 Cross section k (cm ²)	重量 Weight Kg	额定功率 Approx V.A. 0.3mm/50Hz
	G min	F min	A max	B max	D min Tol		E min Tol		R max				
SE60	32.0	10.5	52.2	30.5	19.7	+0.8	9.1	+0.8	1.5	11.4	1.70	0.148	-
SE66	35.0	11.5	57.2	31.5	21.7	+0.8	10.1	+0.8	1.5	12.5	2.08	0.199	-
SE78	42.0	13.5	68.2	39.5	26.1	+0.9	21.1	+0.8	2.0	14.9	3.00	3.422	-
SE84a	45.0	14.5	73.4	42.6	28.0	+1.0	13.1	+10.8	2.0	16.0	3.48	0.426	-
SE84b	-	-	-	-	42.0	-	-	-	-	-	5.23	0.640	-
SE92a	54.0	23	77.6	46.2	23.0	+1.0	10.6	+0.8	2.0	18.7	2.32	0.332	-
SE92b	-	-	-	-	32.0	-	-	-	-	-	3.22	0.461	-
SE106a	59.0	24	88.6	53.2	32.0	+1.0	13.6	+0.8	2.0	20.9	4.13	0.660	-
SE106b	-	-	-	-	45.0	-	-	-	-	-	5.81	0.930	-
SE130a	73.0	30	108.8	65.3	36.0	+1.2	16.5	+0.9	2.0	25.9	5.64	1.117	387
SE130b	-	-	-	-	46.0	-	-	-	-	-	7.21	1.429	484
SE150a	-	-	-	-	40.0	-	-	-	-	-	7.18	1.631	590
SE150b	83.0	35	123.8	75.2	50.0	+1.2	18.9	+0.9	2.0	29.7	8.98	2.040	720
SE150c	-	-	-	-	60.0	-	-	-	-	-	10.80	2.454	860
SE170a	-	-	-	-	54.5	-	-	-	-	-	11.00	2.920	1130
SE170b	100.0	40	145.8	85.0	65.5	+1.5	21.1	+1.0	3.0	34.7	12.90	3.424	1308
SE170c	-	-	-	-	74.5	-	-	-	-	-	14.90	3.955	1490
SE195a	-	-	-	-	55.5	-	-	-	-	-	13.80	4.529	1890
SE195b	130.0	42.5	186.8	98.2	68.5	+1.5	26.2	+1.1	3.0	42.9	17.00	5.579	2250
SE195c	-	-	-	-	83.5	-	-	-	-	-	20.80	6.826	2390
SE231a	-	-	-	-	61.5	-	-	-	-	-	18.00	6.871	3000
SE231b	149.0	50.5	216.0	116.1	77.5	+1.5	30.8	+1.3	3.0	49.9	22.70	8.665	3710
SE231c	-	-	-	-	96.5	-	-	-	-	-	28.20	10.765	4400

SM系列/SM-series

铁芯型号 Code	铁芯尺寸/Dimension (mm)									磁路 长度 Flux path L(cm)	截面积 Cross section k cm ²	重量 Weight Kg	额定功率 Approx V.A. 0.3mm/50Hz
	G min	F min	A max	B max	D min Tol		E min Tol		R max				
SM30a	21.0	7.0	28.6	14.3	6.5	+0.5	3.0	+0.5	1.0	6.6	0.185	0.009	1
SM30b	-	-	-	-	10.5	+0.5	3.0	+0.5	1.0	6.6	0.300	0.015	2
SM42	31.0	9.5	43.6	21.8	14.5	+0.7	5.2	+0.8	1.5	9.8	0.720	0.054	5
SM55	38.5	11.0	56.3	28.4	20.0	+0.8	7.7	+0.8	1.5	12.4	1.460	0.138	21
SM65	45.0	13.0	65.6	33.2	26.2	+0.8	9.0	+0.8	1.5	14.6	2.240	0.250	45
SM74	51.0	14.5	74.6	37.7	31.5	+1.0	10.5	+0.9	1.5	16.5	3.140	0.396	84
SM85a	56.0	14.0	85.6	43.2	31.5	+1.0	13.4	+1.0	2.0	18.3	4.010	0.564	115
SM85b	-	-	-	-	44.5	+1.0	13.4	+1.0	2.0	18.3	5.660	0.792	159
SM102a	68.0	17.5	103.0	51.9	34.5	+1.0	15.9	+1.0	2.0	22.2	5.210	0.885	200
SM102b	-	-	-	-	51.5	+1.0	15.9	+1.0	2.0	22.2	7.780	1.321	300