

C型铁芯/C Core

欧标AJ-HK系列/AJ-HK series

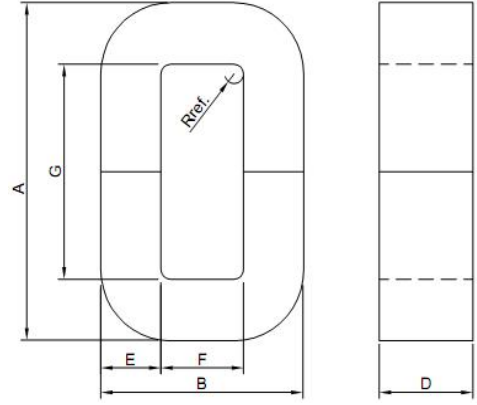

铁芯型号 Code	铁芯尺寸/Dimension (mm)									磁路 长度 Flux path L(cm)	截面积 Cross section k cm ²	重量 Weight Kg	额定功率 Approx V.A.
	G min	F min	A max	B max	D		E		R max				
AJ32	145	56	214	1213	32	33.6	32	33.6	5	49.4	9.73	3.65	
AJ51	-	-	-	-	51	52.6	-	-	-	49.4	15.50	5.82	
AP32	180	70	265	153	32	33.6	40	41.6	5	61.7	12.16	5.70	
AP51	-	-	-	-	51	52.6	40	-	-	-	19.38	9.10	
AS51	230	90	337	194.5	51	53.4	50	52.4	5	78.8	24.20	14.50	
AS70	-	-	-	-	70	72.4	-	-	-	-	33.20	19.90	
AS100	-	-	-	-	100	102.4	-	-	-	-	47.50	28.45	
HB32	196	115	333	249	32	34.4	64	66.4	5	81.4	19.46	12.05	
HB51	-	-	-	-	51	53.4	-	-	-	-	31.00	19.20	
HF38	310	130	439	256	38	40.4	60	62.4	-	106.0	21.70	17.45	
HG38	-	-	519	336	38	40.4	100	102.4	-	118.5	36.10	32.50	
HJ51	356	190	647	298	51	53.4	51	53.4	-	124.4	24.70	23.35	
HK51	-	-	569	400	51	53.4	102	104.4	-	140.4	49.40	52.75	